

Rev.	Description	Date	App. By

Item	Part No.	Qty.	Description
1	.190BBB08	2	10-32 X .750 FH PHIL MS 2AB95
2	.190EBB12	2	10-32 x .750 TH PHIL MACH SCREW
3	.190PAB12	1	10-32 X .750 SHCS
4	PRS001A	1	SLIP RING #SRC032-4
5	XL44 022.4A	1	SLIP RING MOUNTING CLAMP
6	XL44 023.4	1	SLIP RING OFFSET MOUNTING PLATE
7	XL44 044.4A	1	SLIP RING MOUNTING CLAMP SPACER

- Notes:
1. Add Loctite to screw threads before assembling
  2. Tighten enough to secure PRS001A BUT not crush hub

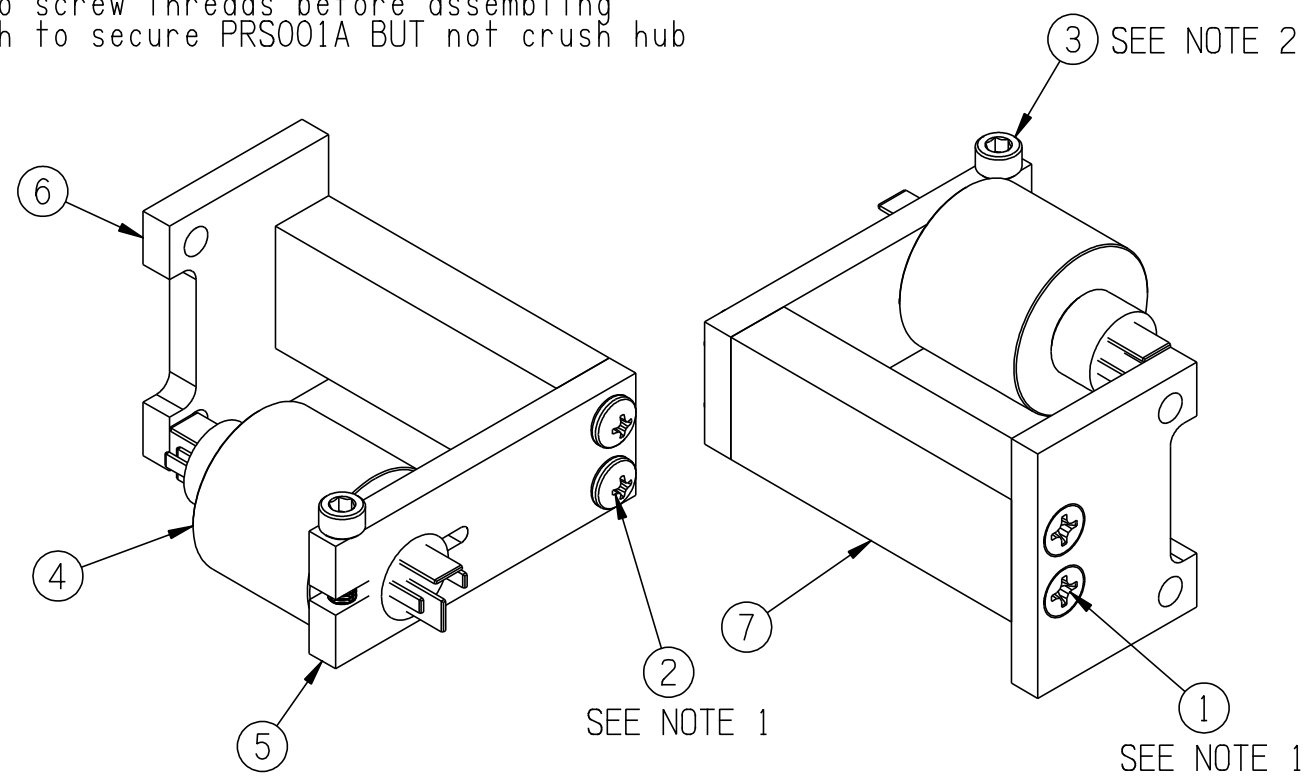

Tolerances Unless Otherwise Specified				
Basic Dimension	UP TO 6.000	6.001 TO 24.000	ABOVE 24.000	∠ ±0° ±30'
2 Place Dim.	±.005	±.010	±.031	
3 Place Dim.	±.002	±.005	±.010	

Finish Specs: NONE



4265 N. Main St., Henlock N.Y. 14466  
 Ph # 585-367-2392 Fax # 585-367-2978