

Part # HRD44 200.5

Title: SLIP RING PRS001 REPLACEMENT ASSEMBLY

Date: 08/21/2013

Rev. Level:

Sheet 1 of 1

Rev.	Description	Date	App. By

Item	Part No.	Qty.	Description
1	.190BBB08	2	10-32 X .750 FH PHIL MS 2AB95
2	.190EBB12	2	10-32 x .750 TH PHIL MACH SCREW
3	.190PAB12	1	10-32 X .750 SHCS
4	.250BAA08	2	.250 X .500 FH SOCKET MACH SCREW
5	HRD44 201.4	1	SLIP RING MOUNTING CLAMP SPACER
6	HRD44 202.4	1	SLIP RING OFFSET MOUNTING PLATE
7	PRS001A	1	SLIP RING #SRC032-4
8	XL44 022.4A	1	SLIP RING MOUNTING CLAMP

Notes:

1. Add Loctite to screw threads before assembling
2. Tighten enough to secure PRS001A but not crush hub
3. Shown in assembled position, do not assemble but ship with other assembled parts for assembly later

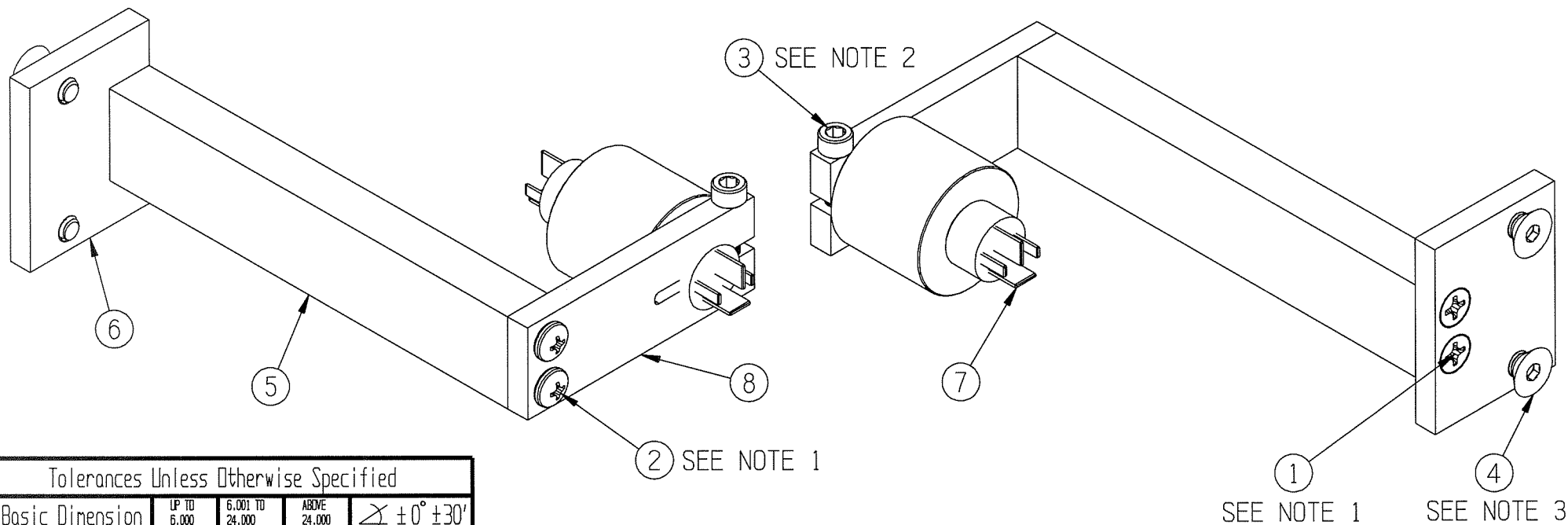

Tolerances Unless Otherwise Specified

Basic Dimension	UP TO 6.000	6.001 TO 24.000	ABOVE 24.000	$\angle \pm 0^\circ \pm 30'$
2 Place Dim.	$\pm .005$	$\pm .010$	$\pm .031$	✓
3 Place Dim.	$\pm .002$	$\pm .005$	$\pm .010$	

Finish Specs: NONE

LED CO INC.4265 N. Main St., Henlock N.Y. 14466
Ph # 585-367-2392 Fax # 585-367-2978

Material Specs: SEE PARTS LIST

L/M

QTY.

WGT.

Drawn By: P.E.T.

App. By:

Date: 08/21/2013